

# No more holes.

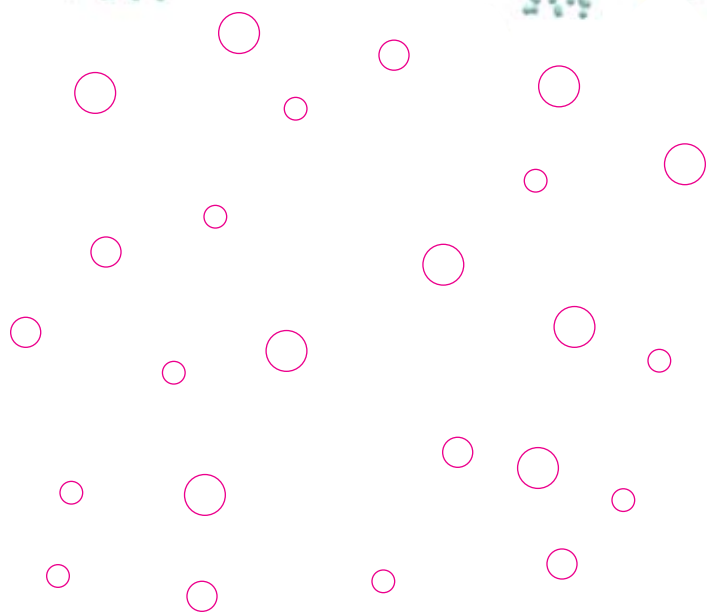

The Chemical Company

BASF Polyurethane  
Foam Enterprises LLC



# WALLTITE® insulating air barrier system.

## Because high performance is more than just Code compliance

### Stop uncontrolled air leakage. Save up to 40 percent on your energy bills.

The WALLTITE® insulating air barrier system from BASF Polyurethane Foam Enterprises LLC goes beyond Code compliance to provide maximum energy efficiency, durability and occupant comfort, health and safety.

The U.S. Department of Energy (DOE) reports that up to 40 percent of the energy cost of heating and cooling a building is wasted by uncontrolled air leakage, which also contributes to premature building deterioration, condensation, spalling, ice damming, poor indoor air quality (IAQ) and mold growth. An effective air barrier system substantially reduces both air leakage and the passage of moisture through the building envelope.

The WALLTITE Insulating Air Barrier system eliminates uncontrolled air leakage by providing seamless, monolithic construction, complete system continuity, superior effective insulation R-value and virtual air impermeability.

### Meet or exceed Code

A ground-breaking report, *Investigation of the Impact of Commercial Building Envelope Airtightness on HVAC Energy Use*, issued in June 2005 by the National Institute of Standards and Technology (NIST), confirmed that air barrier systems can reduce air leakage by up to 83 percent and energy consumption by up to 40 percent. As a result of this report, continuous air barrier systems will be required soon by the American Society

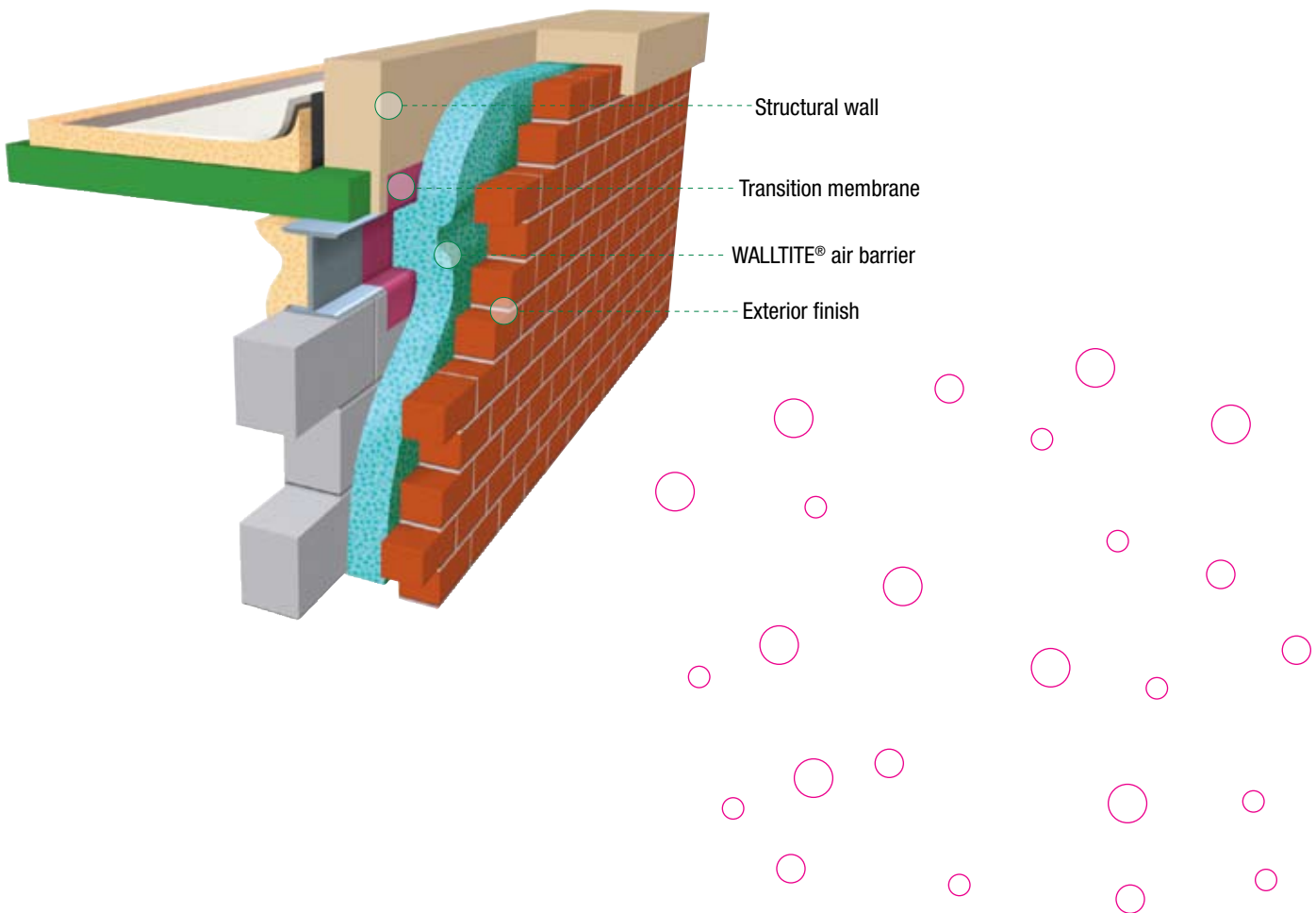

of Heating, Refrigerating and Air-Conditioning Engineers (ASHRAE) under *Addendum z to Standard 90.1-2004, Energy Standard for Buildings Except Low-Rise Residential Buildings*.

Many states are also adopting the air barrier concept into energy Codes. Massachusetts was the first state to incorporate a mandatory air barrier system into its Commercial Energy Code, followed by Michigan and Wisconsin. The goal is to comply with the DOE program targets of reducing building energy consumption by 25 percent by 2010 and by 50 percent by 2020. Several other states are considering adopting similar Code requirements or are expected to adopt the proposed updates to the ASHRAE 90.1 standard.

WALLTITE technology is approved by the Air Barrier Association of America (ABAA) to meet or exceed these Codes and standards.

### Be environmentally responsible

WALLTITE technology uses ZONE3® zero-ozone-depleting blowing-agent technology, emits no volatile organic compounds (VOCs) and is one of the most environmentally

responsible and lowest lifecycle cost systems available. By eliminating condensing surfaces and offering no food source, it also helps to resist mold, mildew and pest infestations, contributing to a safer, healthier indoor environment.

The award-winning BASF Eco-Efficiency Analysis assesses total cost and ecological impact over the product lifecycle to benchmark current performance and get insight for future improvements. The BASF WALLTITE® insulating air barrier system outperformed traditional insulation materials in eco-efficiency on its test scores.

### Third-party quality assurance

When the WALLTITE insulating air barrier system is installed by ABAA-approved applicators as part of an ABAA-specified project, you receive third-party quality control inspection.

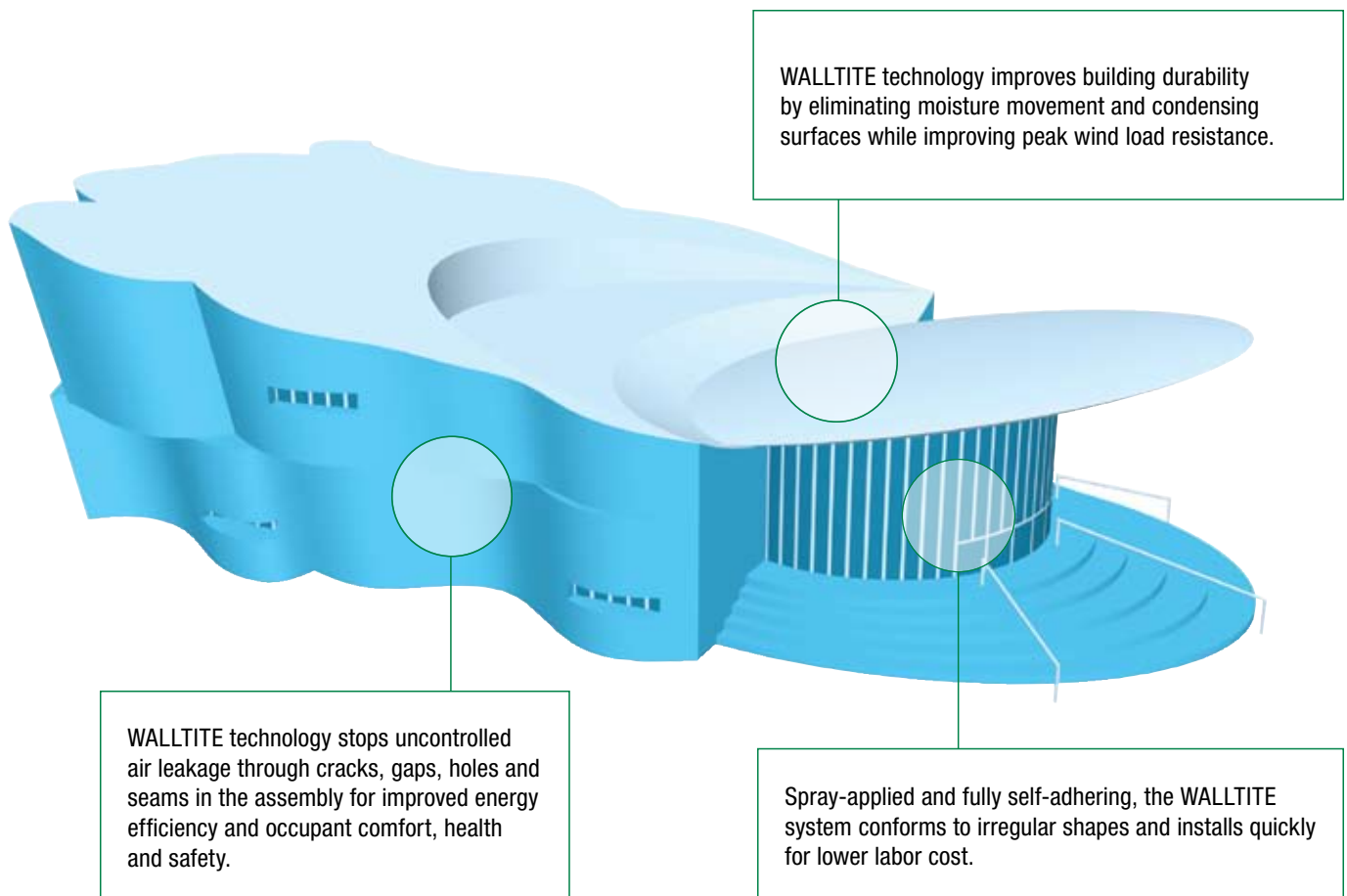



## Compare WALLTITE® technology with other systems

Criteria	WALLTITE®	Glass Fiber	Wool	Blown Cellulose	Open-Cell Foam
R-value per inch <sup>1</sup>	6.0	3.0	3.5	3.0	3.5
Approved Air Barrier System	Yes at 1.5-inch thickness	No	No	No	Yes at 5.5-inch thickness
Seamless Construction	Yes	No	No	No	Yes
Rigid	Yes	No	No	No	No
Fully Adhered	Yes	No	No	No	Yes
Adds Structural Strength	Yes	No	No	No	No
Long Service Life	Yes	No	No	No	Yes
Absorbs Water	<4% v/v	Yes	Yes	Yes	>40% v/v
Allows Moisture Vapor In	No	Yes	Yes	Yes	Yes

Lower installation labor costs and a lifecycle that lasts throughout the building's life expectancy combine to make the WALLTITE system a highly cost-effective solution. And with WALLTITE technology you get air barrier, insulation, drainage plain and in most states, a vapor barrier – all in one product.

Typical applications include:

- Cavity wall
- Precast concrete wall
- Curtain wall

### BASF Polyurethane Foam Enterprises LLC

13630 Watertower Circle  
 Minneapolis, MN 55441  
 Phone: 1-888-900-FOAM  
 Fax: 713-383-4592  
[www.basf-pfe.com/commercial](http://www.basf-pfe.com/commercial)  
[spinfo@basf.com](mailto:spinfo@basf.com)

<sup>1</sup> ASHRAE 2005 Handbook, Chapter 25, Table 4 – Thermal Properties.

